

●温度目盛の比較 Comparison of temperature scales

蒸気圧式目盛(I)
Steam pressure type scale(I)

ガス圧式目盛(II)
Gas pressure type scale(II)

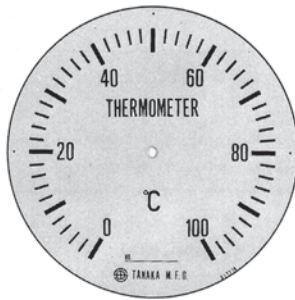
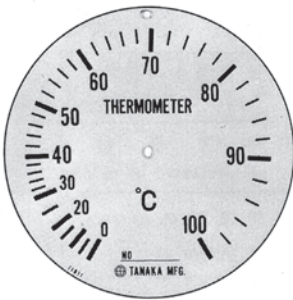

●ネジ込ミフタ
Threaded cover

BN型 BN type

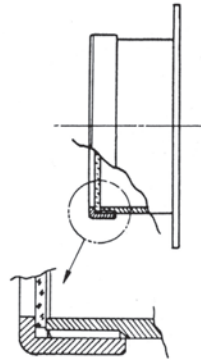

●ハメ込ミフタ
Fitted cover

BR型 BR type

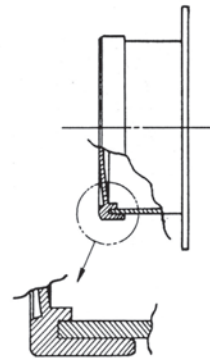

●指示部外箱の形状 Indicator case shape

A型 A type

B型 B type

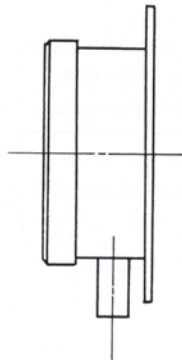
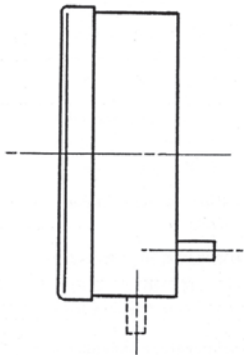

D型 D type

V型 V type

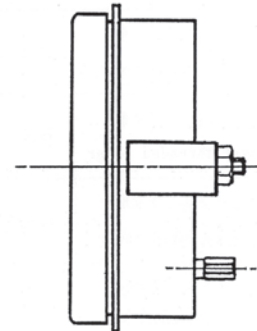

●導管取出口の位置 Leadout tube position

G型 G type

J型 J type

H型 H type

GL型 GL type

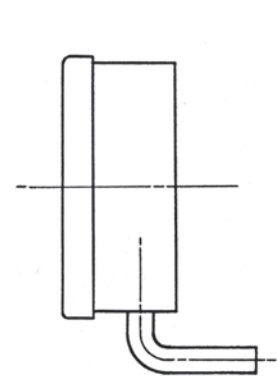
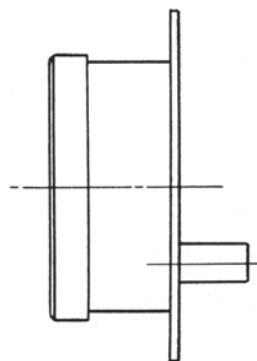
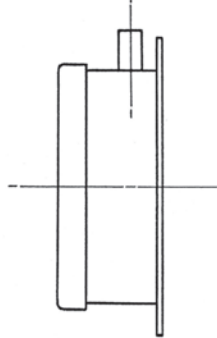
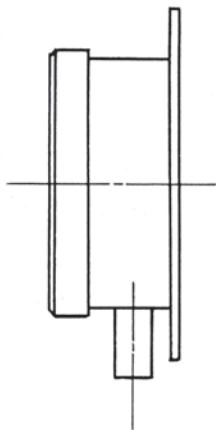

●感温部の形状 Bulb shape

投入形 Insertion type

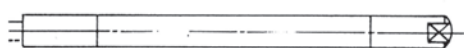

保護管(ウエル)形 Protection tube(well) type



ユニオンネジ形PTネジ Union type PT threads



ユニオンネジ形PFネジ Union type PF threads



●本カタログに記載されている型番・仕様・デザインは、予告無く変更する場合がありますのでご了承下さい。